

Nipple hands Spare parts form - 18 Feb 2010

Customer name

Name – Sir name

Reference

Date

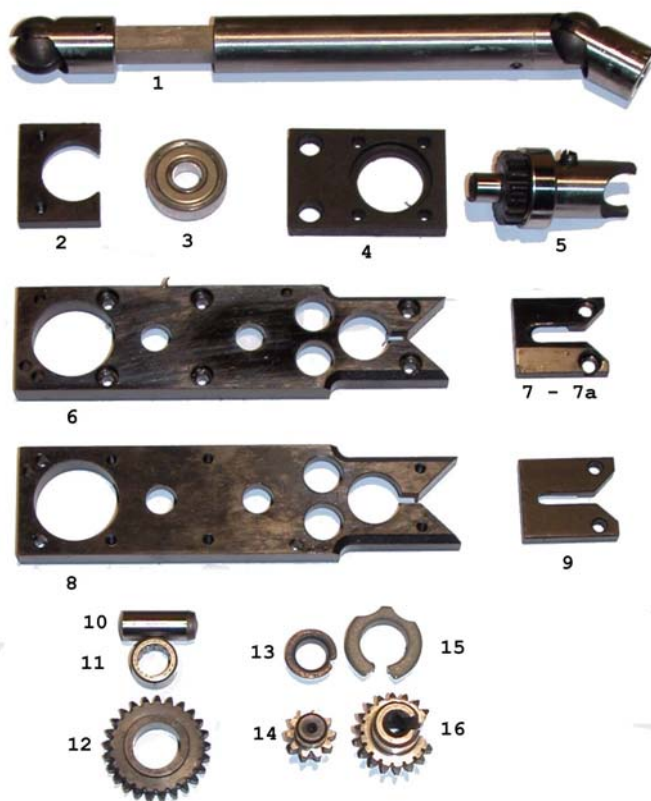

Order quantity – No. Image – Description

- 1 - Cardan axle (0330b250, excl starting fork)
- 2 - Bearing lock up (1107a250)
- 3 - Bearing (1136_250)
- 4 - Bearing plate under (1108b250)
- 5 - Starting gear & Fork (1105a250 including starting fork cardan axle)
- 6 - Top plate nipple hand (1110a250)
- 7 - Spoke guide Top (1112b250, spoke 14)
- 7a - Spoke guide Top (1115a250, spoke 13)
- 8 - Bottom plate nipple hand (1109a250)
- 9 - Spoke guide bottom (1111a250)
- 10 - Cylindrical pin (1199_250)
- 11 - Needle bearing in large gear (1135_250)
- 12 - Large gear (1104_250)
- 13 - Intermediate Bearing (1113_250)
- 14 - Intermediate gear (1106a250)
- 15 - Nipple key bearing (1114_250)
- - 16 - Nipple key (1118a250) 3.3 = Nipple square, check careful.